



SINCE 2002

*POLYPROPYLENE
CENTRIFUGAL
BACK-PULL OUT PUMP*



CHEM-PROOF

*TOTAL
CORROSIIVE
PUMPING SOLUTIONS...*

SERIES - CPB

DEFINATION

Series **"CPB"** Industrial Centrifugal Plastic Pumps are Designed & Manufactured to Meet The Stringent Requirement for Handling Corrosive Liquids Including Moderate Slurries. The Pump Design Confirms to **IS-5120** Standard , Which Gives Higher Efficiency. All Wetted Parts Coming in Contact With The Liquids Are Injected Moulded, Which Can Withstand in Higher Pressures. These Pump Have a Back Pull - Out Construction for Easy Maintenance Without Armour Provides Maximum Protection Against Suction & The Discharge Nozzel of The Pump. Therefore The Pump Can Handle Maximum Misalignment, Distortion & Piping Loads. The Pump Shaft is Protected From Corrosive Media With Reliable Sealing Arrangement. Our Pump Manufacturing Program Ensure Quality, Reliability & Trouble Free Operation for Long Duration.

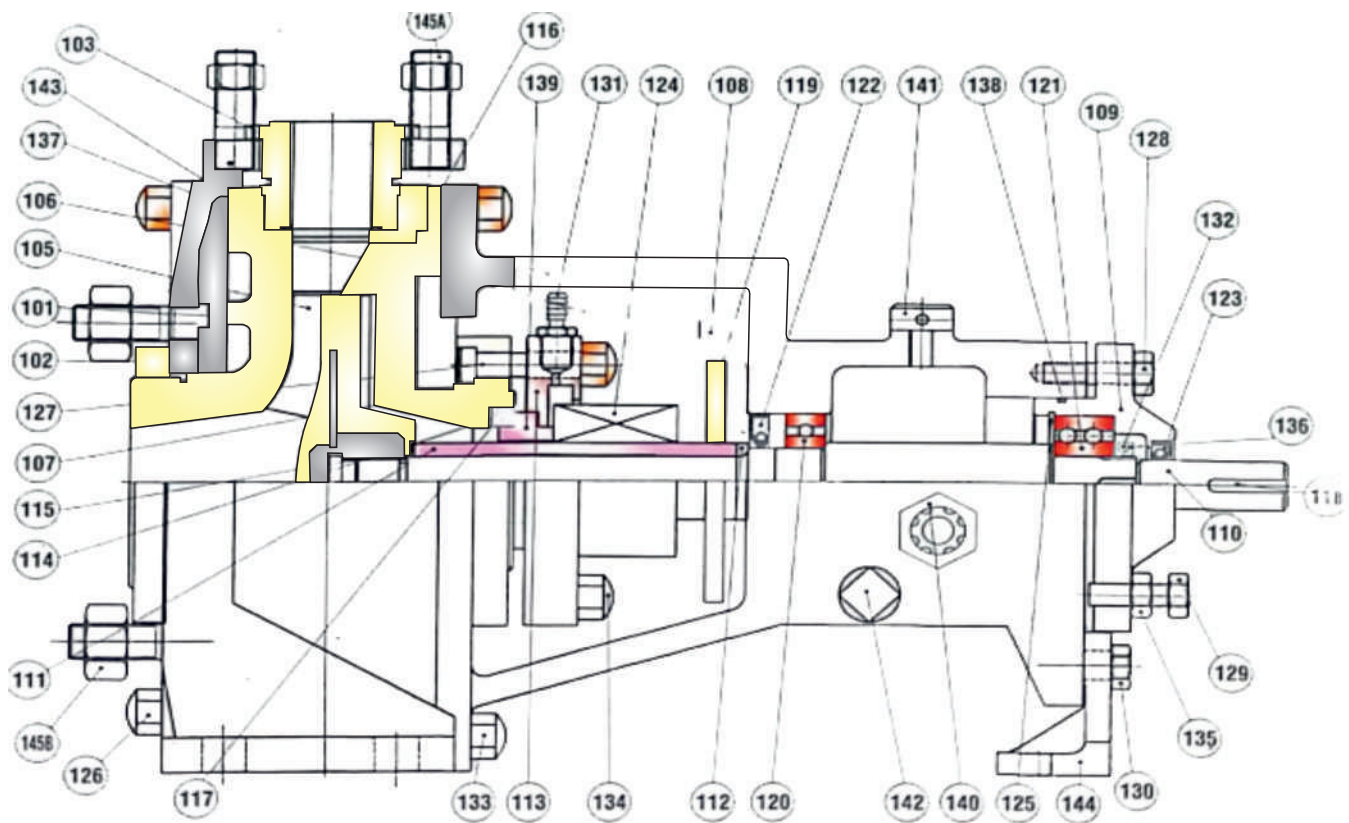

No.	Qty	Part Name	Material	No.	Qty	Part Name	Material	No.	Qty	Part Name	Material
101	1	CASNING	PP/GRP	117	1	GASKET MATING RING	PTFE	133	6	NUT WITH GRP	STEEL WITH GRP
102	1	SUCTION FLANGE	PP/GRP	118	1	KEY	STEEL	134	4	NUT WITH GRP	STEEL WITH GRP
103	1	DISCHARGE BRANCH	PP/GRP	119	1	DEFLECTOR	PP	135	3	LOCK NUT	STEEL
				120	1	INBOARD BEARING	STEEL	136	1	BERING LOCK NUT	STELL
105	1	IMPELLER	PP/GRP	121	1	OUTBOARD BEARING	STEEL	137	1	'O' RING DISCHARGE	VITON
106	1	STUFFING BOX	PP/GRP	122	1	INBOARD OIL SEAL	NEOPRENE	138	1	'O' RING	NEOPRENE
107	1	STUFFING BOX FLANGE	PP	123	1	OUTBOARD OIL SEAL	NEOPRENE	139	1	MATING RING	CERAMIC
108	1	BEARING FRAME	CI	124	1	ROTARY	GFT	140	1	OIL VIEWER	ALLUMINUM
109	1	BEARING CUP	CI	125	1	CIRCLIP (INTERNAL)	STEEL	141	1	BREATHER	STEEL
110	1	SHAFT	En8	126	6	HEX. BOLT	STEEL WITH GRP	142	1	DRINE PLUGE	STEEL
111	1	SLEEVE	HB/CERAMIC/A-20	127	4	HEX.. BOLT	STEEL	143	1	ARMOUR	C.I.
112	1	SLEEVE SUPPORTER	SS316	128	3	HEX.. BOLT	STEEL	144	1	SUPOKT PLATE	C.I.
113	1	GLAND	BAKELITE	129	3	HEX.. BOLT	STEEL	145	4	STUD WITH NUT	STEEL
114	1	CFT BUSH	CFT	130	1	HEX.. BOLT	STEEL	145	4	STUD WITH NUT	STEEL
115	1	IMPELLER GASKET	PTFE	131	2	NIPPLE	PP				
116	1	GASKET CASING	PTFE	132	1	LOCKING WASHER	STEEL				

FAMILY CURVES

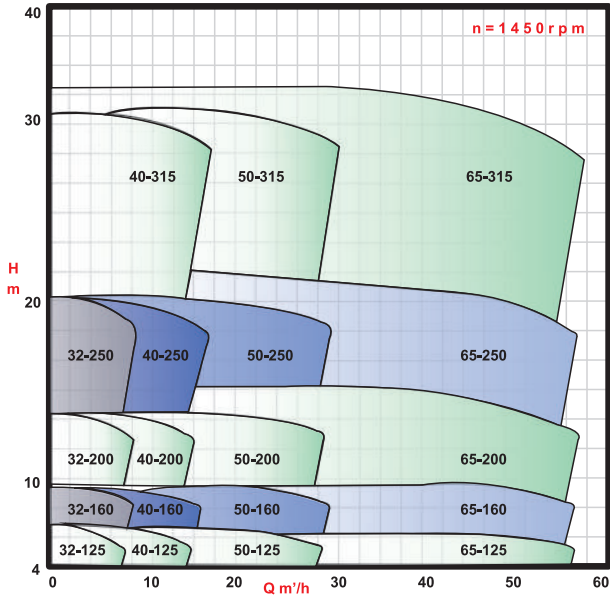

DESIGN CONSTRUCTION DETAILS :-

Casing, stuffing box and impeller are offered in Various Material

- Polypropylene*
 - UHMW
 - Hdpe
 - Glass-fibre Reinforced Polypropylene
 - PTFE
- * Offered as standard

IMPELLER :-

Solidly moulded, semi-open impeller with metal insert ensures high strength and durability. The impeller is dynamically balanced as per ISO 1940 to achieve minimum vibration and extended bearing life.

SHAFT :-

As a standard shaft is offered EN-8 Material. Different materials can be offered on request.

SHAFT SLEEVE :-

Sleeve is protecting the shaft from the attack of corrosive media and can be offered in various materials after confirming chemical compatibility.

- Ceramic (99.5% Alumina Oxide)*
- Silicon Carbide
- Monel
- Alloy-20 (CN7M)
- Hastelloy-B
- Hastelloy-C
- Titanium

* Offered as standard

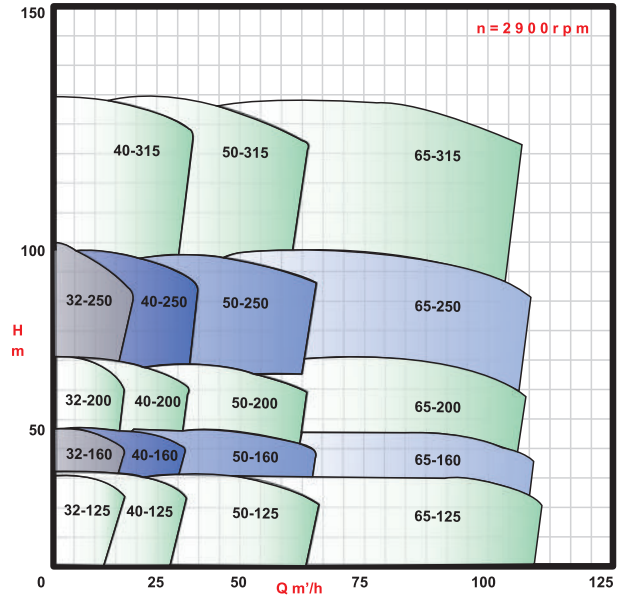

MECHANICAL SEAL:-

As single externally mounted PTFE bellows Mechanical Seal with various face combination is offered after confirming chemical compatibility.

- GFT v/s CERAMIC *
- GFT v/s SILICON
- CARBON v/s CERAMIC
- CARBON v/s SILICON
- SILICON v/s SILICON

* Offered as standard

SEALING :-

'O' Ring and Gaskets Sealing are provided in the joints to ensure better sealing even at high pressure.

ACCESSORIES

PRIMING CHAMBER :-

This is specially used for negative suction. It is effective in handling liquids with slurry or particles, as it does not get clogged as easily as the foot valve.

TROLLEY :-

A specially designed, vibration free trolley keeps the pump mobile, whenever required. Further the trolley can also be provided with FRV coating on the parts exposed to chemical drip.

Liquid handle by our plastic pumps



SINCE 2002

CHEM-PROOF PUMPS (I) PVT. LTD

THE PERFECT PUMPING TECHNOLOGY

G-1602 Raj Estate, Kashmiri Road, Mira road (east), Mumbai 401 103, INDIA.

Phone: +91 9175467779 , 9004407779 , 9004179777

Website: www.chemproofpumps.com E-mail: sales@chemproofpumps.com / chemproof2021@gmail.com

AUTHORISED DEALER



We reserve the right to change specification without notice.